

# Strange

## Kit Summary:

Kit #	C4591WC
Description	10" front carbon brake kit with 2" piston calipers
Page	1 of 2 total pages
Date Modified	Jan 26, 2015

## Kit Contents

ITEM#	PART#	QTY	DESCRIPTION
1	C1780	2	10" carbon rotor
2	B1250E	16	10-24 x 3/8" flat-head socket cap screw
3	B1250W	2	carbon rotor retaining ring
4	B1250S	2	carbon rotor adapter
5	S3402N	26	3/8" AN washer
6	F1282	18	3/8"-24 jet nut
7	S3440D	4	3/8"-24 x 1" bolt
8	B1260AW	2	caliper outer half
9	C4596B	2	1/4"-28 x 0.500 thread insert
10	H1150E	4	3/8"-24 x 0.520" thread insert
11	B1250P	4	carbon brake pad
12	B1260DW	2	outboard "hotdog" bracket
13	B1250H	4	Garlock 08-DU06 bearing ( <i>pre-installed</i> )
14	B1264J	2	bridge bolt tube
15	B1260BZ	2	caliper inner half
16	P2316	2	1/8" x #3AN NPT fitting
17	L4000O	2	1/8" NPT socket plug
18	P2365F	2	1/8" NPT bleeder assembly
19	B5000P2	2	caliper piston
20	B5000T1	2	caliper piston o-ring
21	B3311C	4	slide pin
22	B4595A	2	caliper mounting bracket
23	B1260CW	2	inboard "hotdog" bracket
24	B1260K	4	Garlock 05-DU06 bearing
25	C4596D	4	3/8"-24 x 3-1/4" caliper bolt
26	B1260E	2	1/4" washer
27	C4596E	2	1/4"-28 x 3-1/4" caliper bridge bolt

**FIGURE # 1:** Exploded view of C4591WC

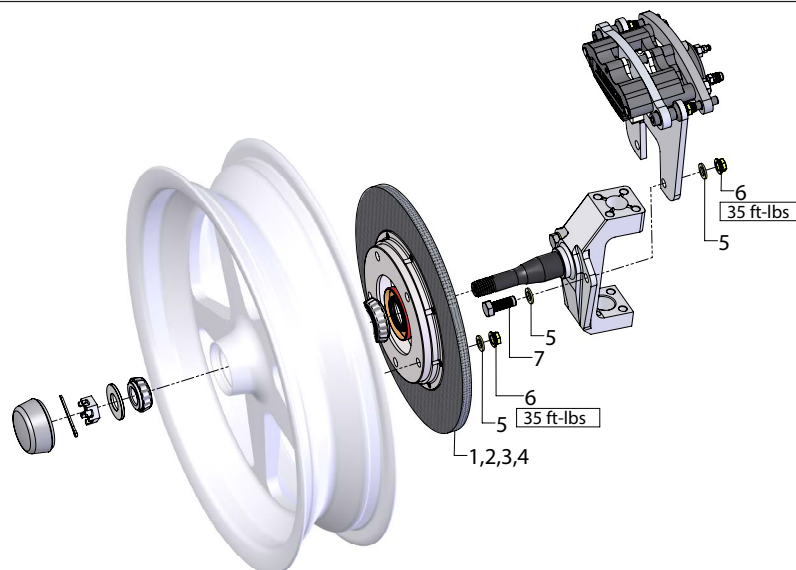

**note:** only components listed in the kit contents section are included

## Brake rotors

Rotors come pre-assembled from Strange Engineering. However, if rotor disassembly is ever required, unscrew the eight flat head socket cap screws (2) and separate the rotor (1) from the rotor retaining ring (3) and rotor adapter (4). Reassemble the brake rotor vise-versa and torque the eight flathead sock cap screws to 35-40 in-lbs.

1. Mount the rotor on the wheel using  $\frac{3}{8}$ " studs supplied with the wheel and the  $\frac{3}{8}$ " washers (5) and jet nuts (6) supplied with this brake kit. Torque to 35 ft-lbs.
2. Disassemble brake caliper by removing caliper bolts (25) and the caliper bridge bolt (27). The slide pins (21) should remain attached to the caliper mounting bracket.
3. Attach the caliper mounting bracket with the slide pins to the spindle body using the two  $\frac{3}{8}$ "-24 bolts (7),  $\frac{3}{8}$ " washers (5) and jet nuts (6). Torque to 35 ft-lbs. Ensure bracket is in correct orientation.
4. Follow the spindle kit instructions to assemble the wheel onto the spindle.
5. Slide the two caliper bolts with the  $\frac{3}{8}$ " washers and the caliper bridge bolt with  $\frac{1}{4}$ " washer (26) through the respective holes on the inboard "hotdog" bracket (23).
6. The caliper must now be assembled onto the caliper bracket. Slide the inboard "hotdog" bracket with the two caliper bolts and the caliper bridge bolt onto the inboard side of the caliper slide pins. The threads on the bolts should face outboard.
7. Feed the caliper inner half (15) over the rotor or through the outside of the wheel and slide through the two caliper bolts and the caliper bridge bolt.
8. Slide the carbon brake pad and caliper bridge bolt tube through the caliper bridge bolt.
9. Slide the outboard "hotdog" bracket through the two caliper slide pins, caliper bolts and caliper bridge bolt.
10. Align a carbon brake pad with the caliper outer half. Finally, line up caliper outer half and carbon brake pad with the two caliper bolts and the caliper bridge bolt. Loosely secure the two caliper bolts and caliper bridge bolt as the caliper outer half is attached.  
Torque caliper bolts (25) to 30 ft-lbs and the bridge bolt (27) to 10 ft-lbs.
11. Connect the hydraulic lines to the calipers. Calipers are tapped to  $\frac{1}{8}$ "-27 NPT and supplied with -3AN fitting. Use proper adapters to connect to existing lines or use new -3AN braided steel line (Teflon lines). Bleed calipers with DOT 4 or DOT 5.1 brake fluid only!

