

Strange

Engineering

8300 North Austin Avenue · Morton Grove IL 60053 · 847-663-1701 · Fax 847-663-1702 · www.strangeengineering.net

Instructions for Strange Engineering B3350 & B3350NR Remote Dragster Forged Aluminum Master Cylinder Kit

Primary External Components for B3350 & B3350 NR

Item #	Part#	Qty.	Description
1	B3350A	1	7/8" bore Remote M.C Body
2	B3362Q	1	Remote M.C Fitting
3	B3362S	2	Banjo Bolt
4	B3362T	2	Banjo Fitting
5	B3362C	1	Pushrod
6	B3362I	1	Pushrod Boot
7	B3350D ¹	1	Remote Reservoir
8	B3362W ¹	2	3/4"-16 Aluminum Nut
9	B3370E ¹	1	M.C. Reservoir Cap

¹Not Included in B3350NR Kit

Plumbing:

- Outlet port (4) is a -3 AN banjo fitting.
- The remote M.C. fitting (2) and outlet on the reservoir (7) are -3 AN fittings.
- The M.C. reservoir (7) is to be plumbed to the remote M.C. fitting (2).

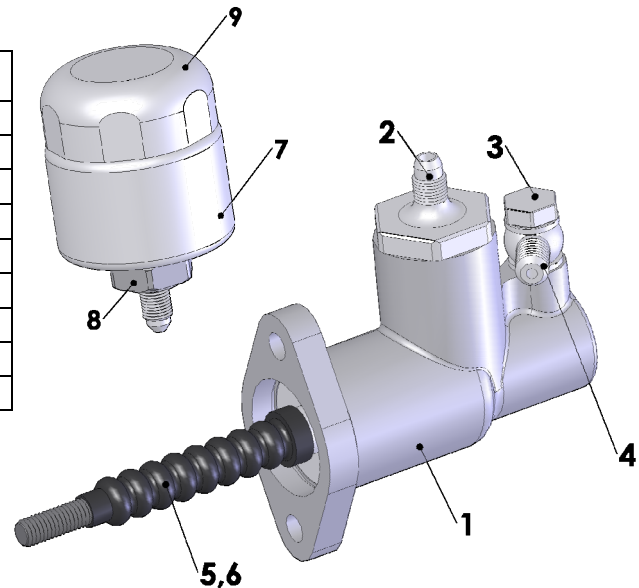

Installation:

- Before installation, the master cylinder **MUST** be bench bled. The majority of soft or spongy brakes results from not bleeding the master cylinder before it is installed. To properly bench bleed the Master:
 1. Run the brake line from the outlet port (4) to the reservoir
 2. Fill the reservoir with DOT 4 or DOT 5.1 brake fluid until the end of the line are covered
 3. Slowly cycle the pushrod in and out until the line is void of air bubbles
- Recommended handle ratio is 10 to 1
- After installation of the master cylinder, the brake system must be bled. Use only DOT 4 or DOT 5.1 brake fluid

Note: During the initial bleeding process the reservoir cap **MUST** be left loose or completely off to let air into the reservoir as the fluid goes down. If the cap is left off, place a rag over the reservoir, as fluid will shoot up from the tank.

Mounting Dimensions:

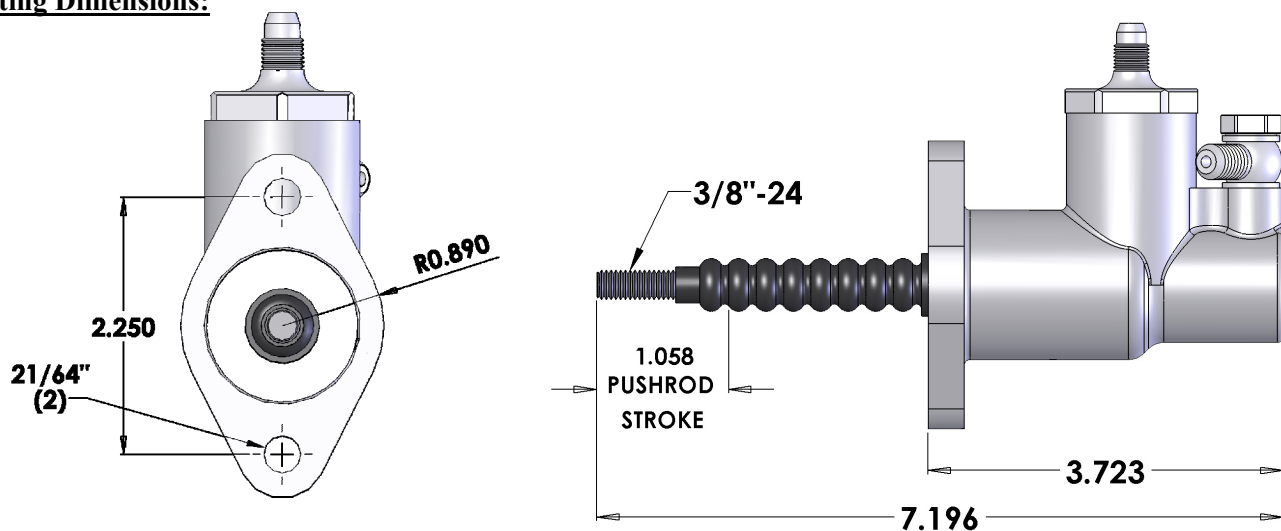

WARNING – RACING IS HAZARDOUS · STRANGE BRAKES ARE FOR LEGAL DRAG RACING ONLY

Disclaimer of Warranty – Purchasers using Strange Engineering racing components and equipment any and all inventory services, purchasers acknowledge that due to differing conditions and circumstances under which all equipment and parts are installed and used, purchasers are not relying on Strange Engineering Co. skill or judgment to select or furnish the proper part or equipment. Purchasers expressly affirm they are relying upon their own skill or judgment to select and purchase suitable goods.

Strange Engineering Co. makes no warranties whatsoever, expressed or implied, oral or written, to purchasers. There is no warranty of merchantability made to purchasers. Strange Engineering Co., further excludes any implied warranty of fitness with respect to racing and equipment, any and all inventory and service.