

Pro Race Steel Front Brake Kits Installation Instructions

Kit

B4134WC 4.75 Bolt Circle

B4133WC 4.75 Bolt Circle

B4132WC 4.50 Bolt Circle

Applications:

67-69 Mustang* 67-69 Cougar* 66-69 Comet*
 66-69 Fairlane 66-69 Falcon 67-69 Ranchero

70-73 Mustang*

70-73 Mustang* **"*" indicates drum spindles only**

BEFORE YOU BEGIN INSTALLATION:

Consult Directional Caliper Kit installation instructions to mount the brake caliper.

Consult pg. 112 of Strange Engineering catalog for available brake lines.

A bearing packer is recommended but not required for this installation.

Remove the stock drum, hub and backing plate assembly from the spindle.

Clean and inspect spindle for damage (spun wheel bearings, stripped threads, etc.).

Inspect upper and lower ball joints for excessive play and replace as needed.

Read these instructions thoroughly and save for future reference. If after reading these installation instructions, you have any questions or comments, please do not hesitate to call us.

IMPORTANT NOTES:

- B2795/B2796 Steel brake rotor minimal thickness is **0.312"**
- B5010 Semi-metallic brake pad minimal thickness is **0.200"**
- Calipers are tapped to 1/8"-27 NPT and supplied with -3AN fittings.
- Strange Engineering brake kits are designed for drag racing only.

Kit Contents

Item #	Part #	Qty.	Description
1	B4154E	2	Hub Cap
2	S3520F	2	Hub Cap O-Ring
3A	B1330D	2	Timken LM12749 Outer Bearing Cone -only w/ B4132WC & B4133WC
3B	B1324D	2	Timken LM11910 Outer Bearing Cone -only w/ B4134WC
4A	B4154SP	2	4.50 Bolt Circle Wheel Hub -only w/ B4132WC
4B	B4154C	2	4.75 Bolt Circle Wheel Hub -only w/ B4134WC & B4133WC
5A	B1330C	2	Timken LM12710 Outer Bearing Cup -pre-installed only w/ B4132WC & B4133WC
5B	B1324E	2	Timken LM11949 Outer Bearing Cup -pre-installed only w/ B4134WC
6A	B1330A	2	Timken L68110 Inner Bearing Cup -pre-installed only w/ B4132WC & B4133WC
6B	B1320J	2	Timken LM67048 Inner Bearing Cup -pre-installed only w/ B4134WC
7	B2795	1	Slotted Brake Rotor -passenger side
8	A1028B	10	1/2" Wheel Stud Washer
9	A1028A	10	1/2-20 x 2.5" Wheel Stud
10A	B1330B	2	Timken L68149 Inner Bearing Cone -only with B4132WC & B4133WC
10B	B1320H	2	Timken LM67010 Inner Bearing Cone -only with B4134WC
11	B1328B	2	Hub Seal
12	S3440D	4	3/8-24 x 1" Caliper Mount Bolt
13	B1850	1	Strange Four Piston Directional Caliper Kit
14	B4134AR	1	Caliper Mounting Bracket -passenger side
15	B1301E	4	3/8-24 Press Nut
16	S3402N	4	3/8 Washer
17	F1282	4	3/8-24 Jet Nut
18	B4134AL	1	Caliper Mounting Bracket -driver side
19	B2796	1	Slotted Brake Rotor -driver side

WARNING – RACING IS HAZARDOUS · STRANGE BRAKES ARE FOR LEGAL DRAG RACING ONLY

Disclaimer of Warranty – Purchasers using Strange Engineering racing components and equipment any and all inventory services, purchasers acknowledge that due to differing conditions and circumstances under which all equipment and parts are installed and used, purchasers are not relying on Strange Engineering Co. skill or judgment to select or furnish the proper part or equipment. Purchasers expressly affirm they are relying upon their own skill or judgment to select and purchase suitable goods. Strange Engineering Co. makes no warranties whatsoever, expressed or implied, oral or written, to purchasers. There is no warranty of merchantability made to purchasers. Strange Engineering Co., further excludes any implied warranty of fitness with respect to racing and equipment, any and all inventory and service.

Installation Instructions

Kit # B4132WC, B4133WC & B4134WC

Figure 1:
Directional Caliper
& Rotors

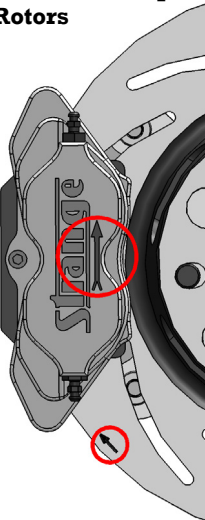

1. Using the two mounting bolts (12), nuts (17) and washers (16), attach the caliper mounting bracket (14) to the spindle body. **Torque the bolts (12) to 35 ft-lbs.**
 - **Note:** The caliper can be mounted either towards the front or rear of the vehicle, but the press nuts always face outboard.
2. Using one 1/2" washer (8) under the head of each 1/2" wheel stud (9), install studs in the hub (4). **Torque the wheel studs (9) to 65 ft-lbs and use blue Loctite. (Figure #2)**
3. Pack the inboard wheel bearing (10) with NLGI 1 wheel bearing grease.
 - **Note:** A bearing packer is recommended for this procedure. If one is not available work as much grease as possible into the cage and around the rollers.
4. Pack the inboard side of the hub with grease and install the inboard wheel bearing (10) into the pre-installed inboard bearing cup (6) in the hub.
5. Press the seal (11) into the inboard side of the hub (4)
6. Slide the hub assembly with components onto the spindle.
7. Pack the outboard side of the hub with grease.
8. Pack the outboard bearing (3) with grease and slide it over the spindle into the outboard bearing cup (5).
9. Install the spindle nut washer and nut.
10. Install the wheel and tire on the hub and snug the wheel lugs.
11. While rotating the wheel, torque the spindle nut to approximately 20 ft-lbs.
12. Back the spindle nut off until the wheel spins freely and there is no end play. Install the cotter pin.
13. Remove wheel and tire.

14. Slide the rotor (7) over the wheel studs, flush to the face of the hub (5).

■ **Note:** Slotted rotors mount with the arrow at the top pointing towards the front of the vehicle, indicating the direction of wheel rotation. **(Figure #1)**

15. Install the hub cap (1) with the o-ring (2).

16. Consult Directional Caliper Kit installation instructions to mount the caliper and install the brake pads.

■ **Notes:** The arrow on the caliper must face the normal rotation of the rotor/wheel. **(Figure #1)**

The number of shims used to center the caliper with the rotor will vary because not all spindles are exactly identical. Therefore, determine the proper amount of shims by positioning the caliper as closely as possible to the center of the rotor. Also, the passenger and driver side do not necessarily use the same amount of shims.

17. Connect the hydraulic lines to the calipers. Calipers are tapped to 1/8"-27 NPT and supplied with -3AN fittings.

Use proper adapters to connect or use new -3AN braided steel line (teflon lined). Bleed the calipers with DOT 4 or DOT 5.1 brake fluid **ONLY**.

18. A proper break in procedure is required to avoid brake fade and uneven rotor deposits from the pads. It consists of 8-10 brake applications increasing in harshness while allowing the brakes to cool slightly in between; do not keep the brakes applied between stops. After the last stop the brakes should be allowed to cool completely.

Figure 2: Passenger Side Brake Kit Assembly

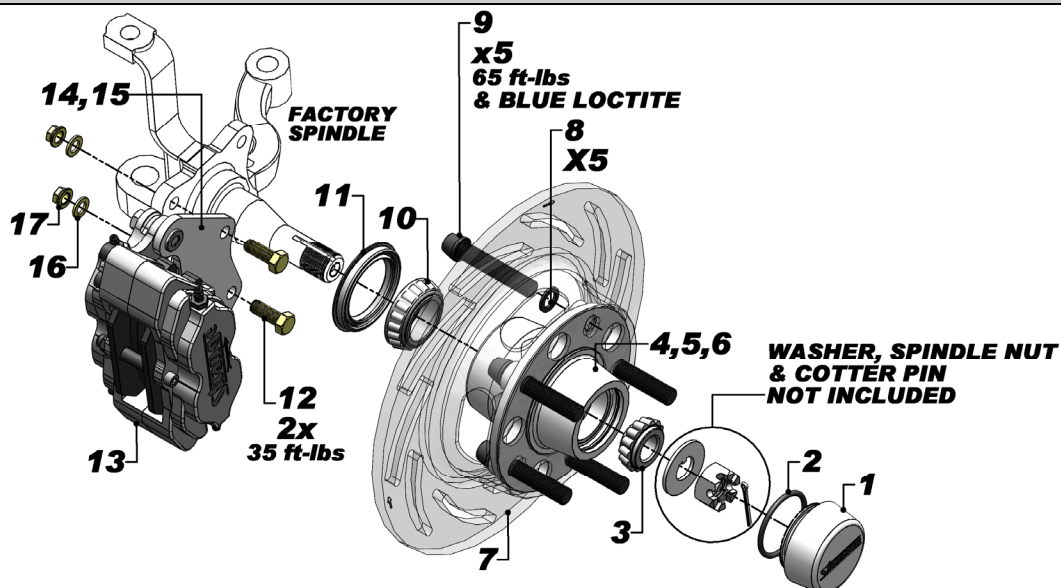

Note: Consult Directional Caliper Kit installation instructions to mount the caliper and install the brake pads.