



Strange



EVOLUTION 2-PISTON DDM FRONT BALL BEARING BRAKE KIT INSTRUCTIONS

KIT #
B4753WCE - 4-1/2" B.C
B4754WCE - 4-3/4" B.C

APPLICATIONS
1987-present Strange Forged Aluminum Struts

Evolution Rotors

- Dynamic Drive Mount (DDM) system secures the rotor and allows for rotor thermal expansion
- DDM system design is secured by an internal Spirolox, eliminating heavy bolts and hardware
- Unique Aero Slot design reduces rotating weight and promotes even heat dissipation

Evolution 2 Piston Kit

- Low friction Ball Bearings, Steel and Ceramic available
- Weight: 19.65 lbs
- Minimum Rotor thickness: 0.260"
- Minimum Pad Thickness: 0.200"
- Low friction seal and stainless steel seal rings

Before you begin installation:

-Strange Engineering brake kits are designed for DRAG RACING ONLY!

-Read these instructions thoroughly and save for future reference.

-If after reading these installation instructions, you have any questions or comments, please do not hesitate to call us.

KIT CONTENTS

ITEM#	PART#	QTY	DESCRIPTION
1	B1500H	2	Evolution Aluminum hub cap
2	S3520F	2	#222 Buna O-ring (pre-installed on B1500H)
3	B1500F	2	Evolution 0.751" ID outboard bearing sleeve
5a	B1554SP	2	Front hub "HS" 4.50" B.C. (B4753WCE)
5b	B1554C	2	Front Hub "H" 4.75" B.C (B4754WCE)
6	A1028B	10	1/2" I.D. Wheel stud washer
7	A1028A	10	1/2"-20 x 2.5" Wheel stud
8	B2798AS	2	11" Evolution S Rotor
9	B2794D	2	Spirolok
11	B1500I	2	Hub seal
12	B1500E	2	Evolution 1.251" ID inboard bearing sleeve
13	B4122D	4	7/16-14 x 1.750" FHSCS
14	S3402N	4	3/8 AN washer
15a	B4754A	1	R.H. Caliper Mounting Bracket
15b	B4754B	1	L.H. Caliper Mounting Bracket
16	B1301E	4	3/8"-24 Press nut (pre-installed in B4754AL & B4754AR)
17	B1301H	16	3/8" I.D. x 0.025" Thick caliper shim
18	B1835	2	2-piston Evolution caliper
19	B2510	4	Soft Metallic 2-piston caliper pad
20	P2316	2	1/8" NPT x -3AN Fitting
21	B1301J	4	3/8" I.D. x 1.0625" Thick caliper washer
22	S3440D	4	3/8"-24 x 1.000" Caliper bolt
23	F1282	4	3/8-24 Jet nut

Ball Bearing Kits

B1500SKIT Steel Ball Bearing kit content

B1500CKIT Ceramic Ball Bearing kit content

ITEM#	PART#	QTY	DESCRIPTION	ITEM#	PART#	QTY	DESCRIPTION
4a	B1500B	2	Outboard Steel Ball bearing	4b	B1500BC	2	Outboard Ceramic Ball bearing
10a	B1500A	2	Inboard Steel Ball bearing	10b	B1500AC	2	Inboard Ceramic Ball bearing

Figure # 1

Installation instructions



1. Raise and support front of vehicle on a level surface using suitable equipment.
2. Remove wheel, caliper, rotor, hub, and brake line. Inspect all ball joints for excessive play and replace as needed.
3. Install the caliper mount (15) using the caliper bracket bolts (13), washers (14) and locknut (23)
4. Slide the hub assembly onto the spindle, install the key washer and the spindle nut.
Note: Evolution rotors mount with the arrow pointing in the direction of normal rotation (See Figure #1).
5. Tighten the spindle nut until the hub has no end play and spins freely.
6. Install the stamped spindle nut retainer, cotter pin, aluminium hub cap (1,2)
7. Attach caliper (18) using 3/8"-24 caliper bolts (22) with red loctite and 3/8" I.D. washers (21). Use 3/8" I.D. caliper shims (17) to center the caliper over the rotor, making sure pads contact the rotor evenly. The caliper bolt (22) should be fully engaged into the press nut.
Note: Please read B1835 instructions for complete caliper instructions.
8. Torque the caliper mounting bolts (22) to 35 ft-lbs.
 Connect the brake lines to the calipers. Calipers are tapped to 1/8"-27 NPT and supplied with -3AN fittings.
9. Use proper adapters to connect them to existing lines or use new -3AN braided steel line (teflon lined). Bleed the calipers with DOT 4 or DOT 5.1 brake fluid ONLY.
10. A proper break in procedure is required to avoid brake fade and uneven rotor deposits from the pads. It consists of 8-10 brake applications increasing in harshness while allowing the brakes to cool slightly in between; do not keep the brakes applied between stops. After the last stop the brakes should be allowed to cool completely.

FIGURE # 2: B4753WCE/B4754WCE Exploded view

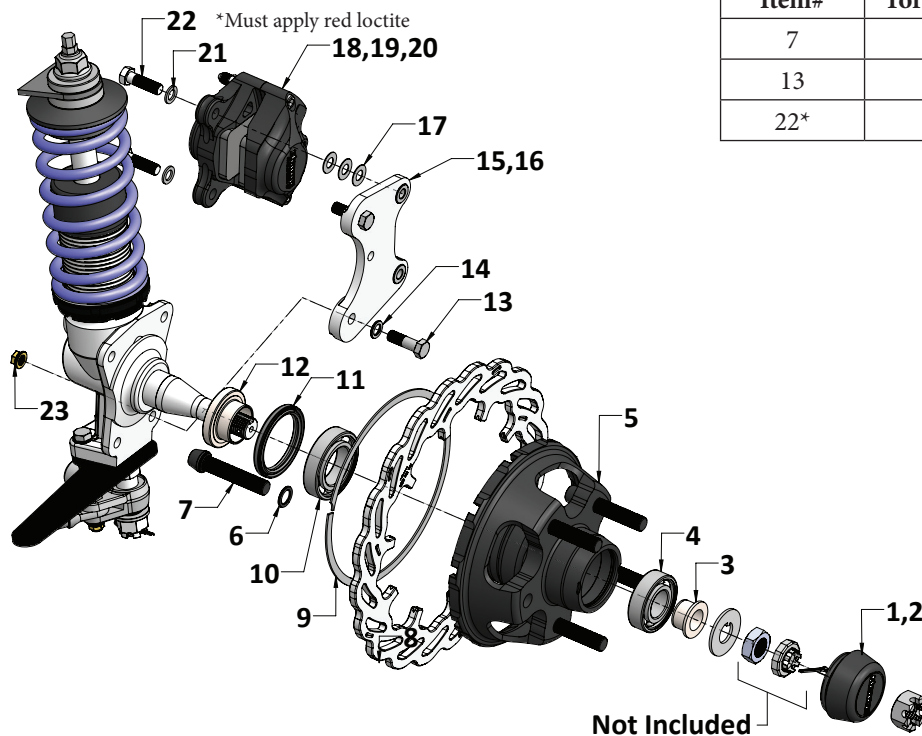

Item#	Torque spec (ft-lbs)
7	65
13	35
22*	35

WARNING - RACING IS HAZARDOUS · STRANGE BRAKES ARE FOR LEGAL DRAG RACING ONLY

Disclaimer of Warranty - Purchasers using Strange Engineering racing components and equipment any and all inventory services, purchasers acknowledge that due to differing conditions and circumstances under which all equipment and parts are installed and used, purchasers are not relying on Strange Engineering Co. skill or judgment to select or furnish the proper part or equipment. Purchasers expressly affirm they are relying upon their own skill or judgment to select and purchase suitable goods.

Strange Engineering Co. makes no warranties whatsoever, expressed or implied, oral or written, to purchasers. There is no warranty of merchantability made to purchasers. Strange Engineering Co., further excludes any implied warranty of fitness with respect to racing and equipment, any and all inventory and service.