

Strange

•847-663-1701•

April 9 2021

CAMARO FRONT BRAKE KIT INSTALLATION INSTRUCTIONS

Installation to be performed by a qualified technician.

BRAKE KIT #

B4181WC, B4181WC2

APPLICATIONS

2010-2015 Camaro

Important Notes

- All 11.25" steel rotors have 0.312" minimal thickness.
- B5010 semi-metallic brake pads have 0.200" minimal thickness.
- Strange Engineering brake kits are designed for **DRAG RACING ONLY!**
- Knuckles will need a modification made to them, refer to Figures #3.
- Refer Figure #4 only if 2-piece rotors are being installed.

Before you begin installation

- Consult factory service manual to remove and disassemble the calipers and axle hub assembly.
- Brake fittings do not come pre-installed, it will need a layer of Teflon sealer applied to the thread (Figure#2 for torque specs)
- Brake rotors are shipped with an oil film on surface to prevent rust and must be cleaned before installation.
- Read these instructions thoroughly and save for future reference.
- If after reading these installation instructions, you have any questions or comments, please do not hesitate to call us.

B4181WC Kit CONTENTS			
ITEM#	PART#	QTY	DESCRIPTION
1	B2792	1	Right hand Rotor
2	B2793	1	Left hand Rotor
-	B2794A	2	2-Piece rear rotor (B4181WC2)
-	B2794B	2	2-Piece rear adapter (B4181WC2)
-	B2794D	2	2-piece rotor spirolock (B4181WC2)
3	B4181B	1	Rotor Spacer
4	B4181C	4	M14 x 2 x 70mm FHSCS
5	B1301E	4	3/8-24 Press Nut
6	B4181D	2	Caliper Bracket
7	B1301H	16	3/8 ID x .025 Thick Shim
8	B5002	1	4 Piston Caliper Right hand
9	B5004	1	4 Piston Caliper Left hand
10	B5010	4	Semi metallic pad
11	P2316	2	1/8NPT x #3AN Fitting
12	B1301J	4	Washer-3/8 ID 1/16 TK.Flat
13	B5000Y	4	3/8-24 x 1-1/4" HHCS GR.8
14	B4184D	4	M14 x 2 Nylok Nut
-	P2316C	2	Plastic cap for P2316

CAMARO

Installation instructions

- FIGURE # 1:**
1. Raise and support front of vehicle on a level surface using suitable equipment.
 2. Remove wheel, caliper, rotor, hub, and brake line. Inspect all ball joints for excessive play and replace as needed.
 3. Remove the knuckle, following factory handbook or on-line resources.
 4. Perform proper modifications to the spindle ears (Figure #3), if using 2-piece rotors use Figure #4 as well.
 5. Place the stock hub into the knuckle, torque the hub assembly bolts to 85 ft-lbs.
 6. Slide the Rotor Spacer (3) onto the hub assembly. **Ensure the register faces outboard.**
 7. Attach the caliper bracket (6) using the FHSCS (4) and the nut (14) to the knuckle.
 8. Slide the rotor (1,2) over the wheel studs flush to the face of the rotor spacer (3).
Note: Rotors mount with the arrow pointing in the direction of normal rotation. (Figure #1)
 9. Using the HHCS (13), washer (12) and shims (7) to fasten the caliper (8,9) on the caliper bracket (6).
Note: The arrow on the caliper must face the normal rotation of the rotor/wheel. (See Figure #1)
 10. Determine the proper amount of shims by positioning the caliper as closely as possible to the center of the rotor.
 11. Connect the hydraulic lines to the calipers. Calipers are tapped to 1/8"-27 NPT and supplied with -3AN fittings. Use proper adapters or use new -3AN braided steel line (teflon lined). Bleed the calipers with DOT 4 or DOT 5.1 brake fluid ONLY.
 12. A proper break-in procedure is required to avoid brake fade and uneven rotor deposits from the pads. It consists of 8-10 brake applications increasing in harshness while allowing the brakes to cool slightly in between; do not keep the brakes applied between stops. After the last stop the brakes should be allowed to cool completely.

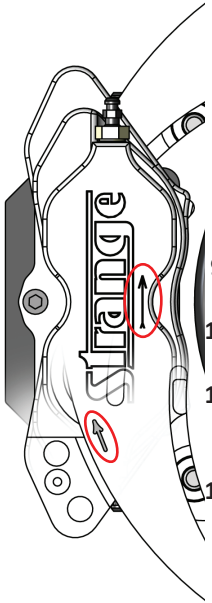

FIGURE # 2: Exploded view of B4181WC

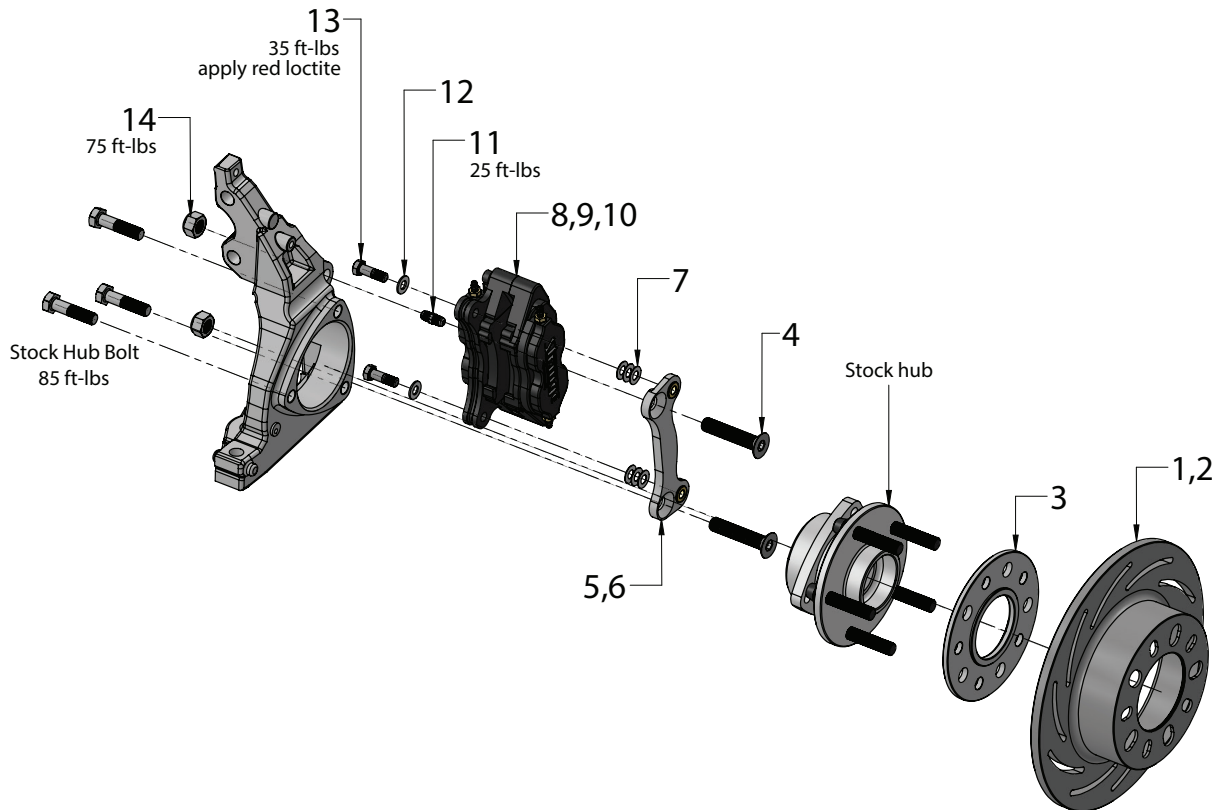

FIGURE # 3: 2010-2015 Knuckle ear modification

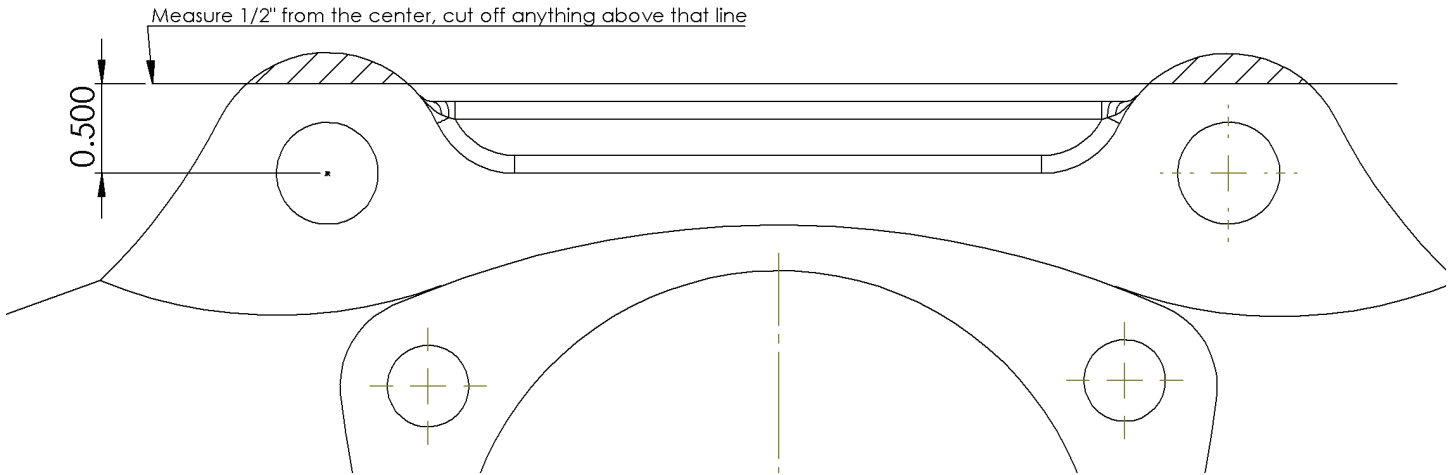
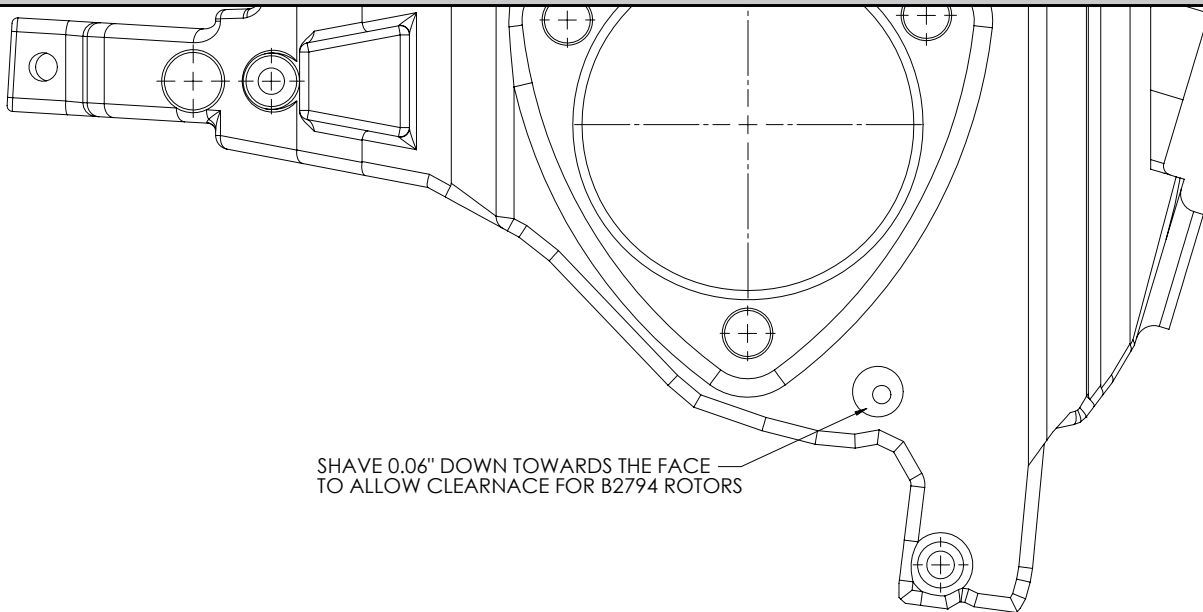

FIGURE # 4: 2010-2015 Knuckle modification for 2-piece Rotors



WARNING - RACING IS HAZARDOUS · STRANGE BRAKES ARE FOR LEGAL DRAG RACING ONLY

Disclaimer of Warranty – Purchasers using Strange Engineering racing components and equipment any and all inventory services, purchasers acknowledge that due to differing conditions and circumstances under which all equipment and parts are installed and used, purchasers are not relying on Strange Engineering Co. skill or judgment to select or furnish the proper part or equipment. Purchasers expressly affirm they are relying upon their own skill or judgment to select and purchase suitable goods.

Strange Engineering Co. makes no warranties whatsoever, expressed or implied, oral or written, to purchasers. There is no warranty of merchantability made to purchasers. Strange Engineering Co., further excludes any implied warranty of fitness with respect to racing and equipment, any and all inventory and service.