

Strange

Page 1 of 3

April 9 2021

CAMARO FRONT BRAKE KIT INSTALLATION INSTRUCTIONS

Installation to be performed by a qualified technician.

BRAKE KIT

B4181WC-16

B4181WC2-16

APPLICATIONS

2016-2024 Camaro

Important Notes

- All 11.25" steel rotors have 0.312" minimal thickness.
- B5010 semi-metallic brake pads have 0.200" minimal thickness.
- Knuckles need modifications made to them, refer to Figures #3 & #4.
- Strange Engineering brake kits are designed for DRAG RACING ONLY!

Before you begin installation

- Consult factory service manual to remove and disassemble the upright and axle hub assembly.
- Brake fittings do not come pre-installed, it will need a layer of Teflon sealer applied to the thread (Figure#2 for torque specs)
- Brake rotors are shipped with an oil film on surface to prevent rust and must be cleaned before installation.
- Read these instructions thoroughly and save for future reference.
- If after reading these installation instructions, you have any questions or comments, please do not hesitate to call us.

B4181WC-16 KIT CONTENTS

ITEM#	PART#	QTY	DESCRIPTION
1	B2792	1	Right hand Rotor
2	B2793	1	Left hand Rotor
-	B2794A	2	2-Piece rear rotor (B4181WC2-16)
-	B2794B	2	2-Piece rear adapter (B4181WC2-16)
-	B2794D	2	2-piece rotor spirolock (B4181WC2-16)
3	B4181B	1	Rotor Spacer
4	A1028A	10	1/2-20 X 2-1/2 Taper head SHCS
5	B1301E	4	3/-24 Press nut
6	B4181D	2	Caliper bracket
7	B1301H	16	3/8 ID x 0.25 thick shim
8	B5002	1	4 Piston Caliper Right hand
9	B5004	1	4 Piston Caliper Left hand
10	B5010	4	Semi metallic caliper pad
11	P2316	2	-1/8NPT x #3AN Fitting
12	B1301J	4	Washer -3/8 ID 1/16 Thick shim
13	B5000Y	4	3/8-24 x 1.125" HHCS GR.8
14	B4181E	4	Caliper bracket stand
15	B4184D	4	M14 x 2 Nylock nut
16	B4181C	4	M14 x 2 x 70mm FHSCS

WARNING - RACING IS HAZARDOUS · STRANGE BRAKES ARE FOR LEGAL DRAG RACING ONLY

Disclaimer of Warranty – Purchasers using Strange Engineering racing components and equipment any and all inventory services, purchasers acknowledge that due to differing conditions and circumstances under which all equipment and parts are installed and used, purchasers are not relying on Strange Engineering Co. skill or judgment to select or furnish the proper part or equipment. Purchasers expressly affirm they are relying upon their own skill or judgment to select and purchase suitable goods.

Strange Engineering Co. makes no warranties whatsoever, expressed or implied, oral or written, to purchasers. There is no warranty of merchantability made to purchasers. Strange Engineering Co., further excludes any implied warranty of fitness with respect to racing and equipment, any and all inventory and service.

CAMARO

Installation instructions

FIGURE # 1:

1. Raise and support front of vehicle on a level surface using suitable equipment.
2. Remove wheel, caliper, rotor, hub, and brake line. Inspect all ball joints for excessive play and replace as needed.
3. Remove the knuckle, following factory handbook or on-line resources.
4. Perform proper modifications to the knuckle ears (Figure #3) and rotor (Figure #4) as well.
5. Place the stock hub into the knuckle, torque the hub assembly bolts to 85 ft-lbs.
6. Slide the Rotor Spacer (3) onto the hub assembly. **Ensure the register faces outboard.**
7. Attach the caliper bracket (6) using the FHSCS (4) and the nut (15) to the knuckle.
8. Spacers (14) are required between knuckle and inboard side of caliper bracket (6)
9. Slide the rotor (5) over the wheel studs flush to the face of the rotor spacer (3).
Note: Rotors mount with the arrow pointing in the direction of normal rotation. (Figure #1)
10. Using the HHCS (13), washer (12) and shims (7) to fasten the caliper (8,9) on the caliper bracket (6).
Note: The arrow on the caliper must face the normal rotation of the rotor/wheel. (See Figure #1)
 Determine the proper amount of shims by positioning the caliper as closely as possible to the center of the rotor.
11. Connect the hydraulic lines to the calipers. Calipers are tapped to 1/8"-27 NPT and supplied with -3AN fittings. Use proper adapters or use new -3AN braided steel line (teflon lined). Bleed the calipers with DOT 4 or DOT 5.1 brake fluid ONLY.
12. A proper break-in procedure is required to avoid brake fade and uneven rotor deposits from the pads. It consists of 8-10 brake applications increasing in harshness while allowing the brakes to cool slightly in between; do not keep the brakes applied between stops. After the last stop the brakes should be allowed to cool completely.

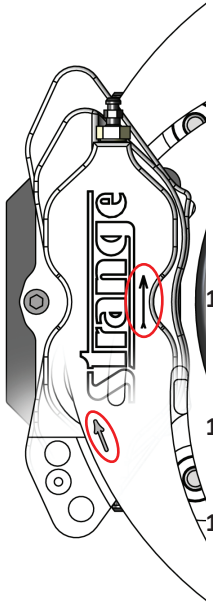
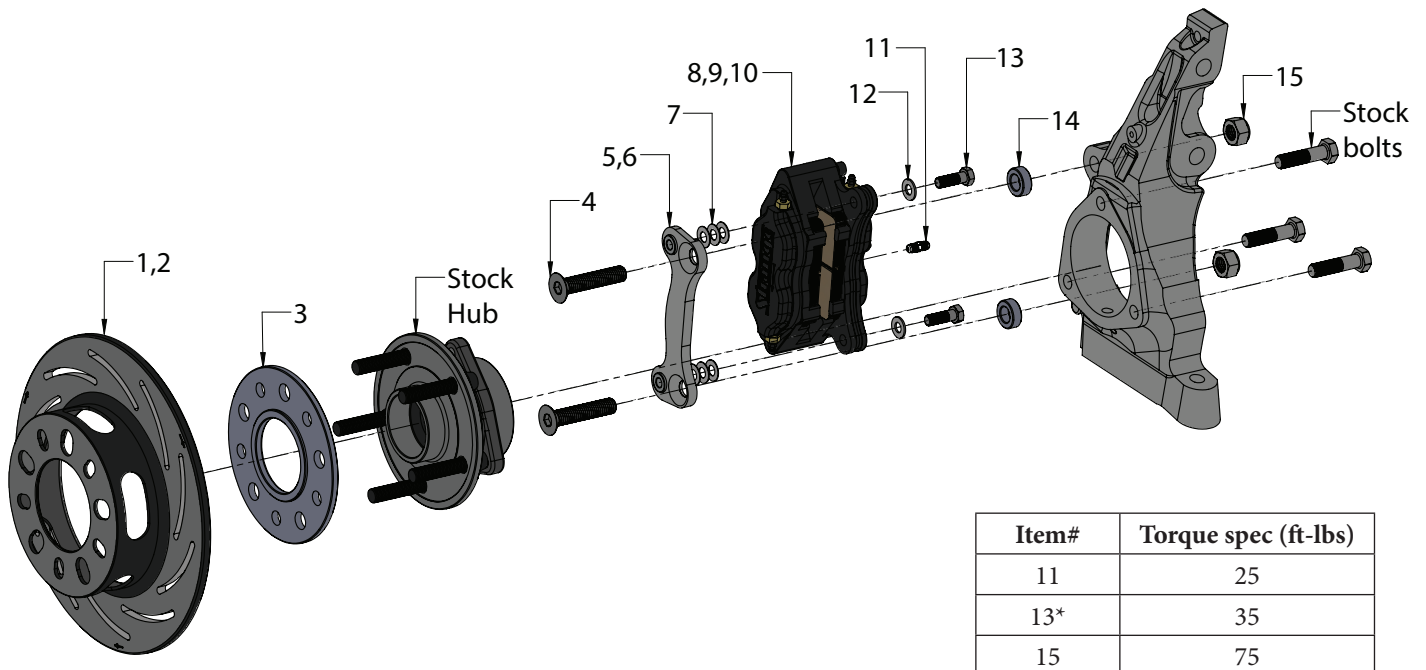

FIGURE # 2: Exploded view of B4181WC-16



Item#	Torque spec (ft-lbs)
11	25
13*	35
15	75

*Must apply red loctite

FIGURE # 3: Knuckle ear modification

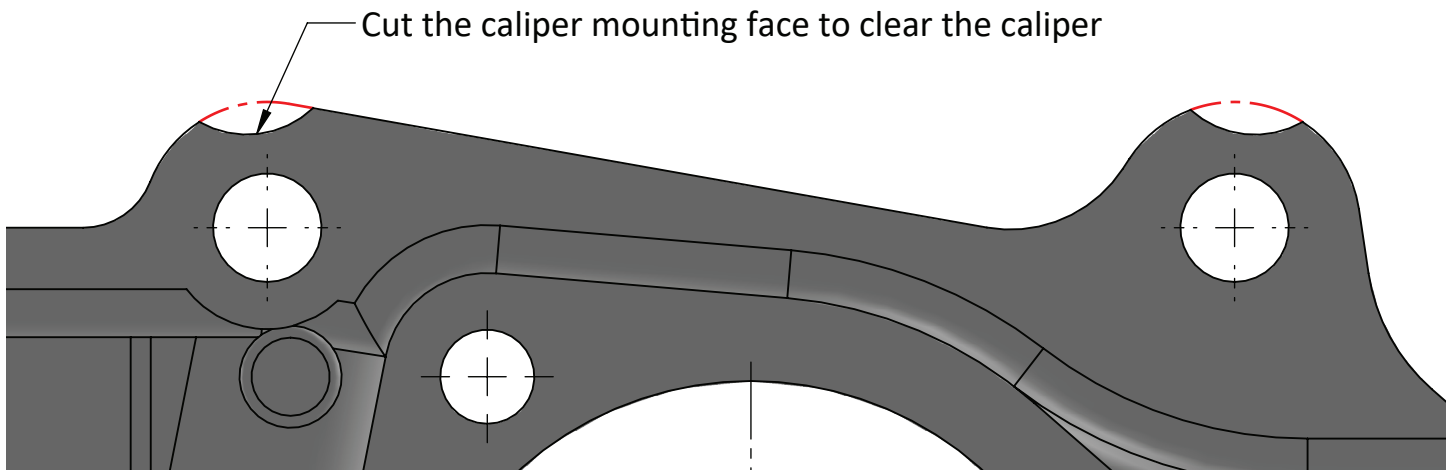

FIGURE # 4: Knuckle modification for rotor clearance

